

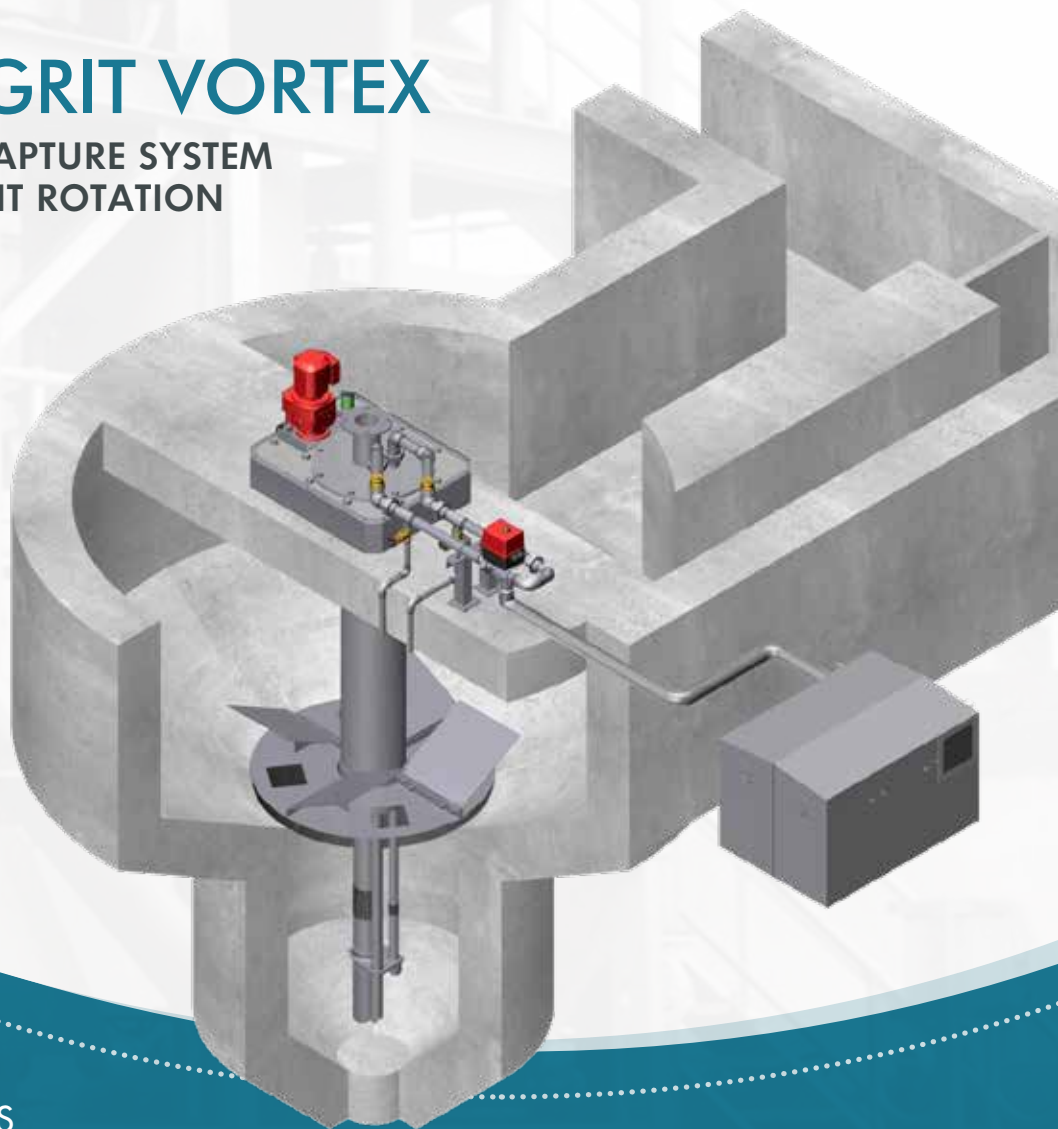

SPIRAC[®]
Solid Handling Solutions

SPIROSEP[®] GRIT VORTEX

GRIT SEPARATION CAPTURE SYSTEM
THROUGH CONSTANT ROTATION



FEATURES & BENEFITS

- ◆ Low capital cost and low power consumption.
- ◆ Rotating impeller creates a lift zone to ensure organics and lighter particles remain in suspension.
- ◆ Few moving parts therefore low maintenance.
- ◆ Simple and reliable operation due to low head loss.
- ◆ Effective across a wide flow and grit load range.
- ◆ Can be supplied as a complete grit capture and washing system in combination with the SPIRAC Grit Washer.

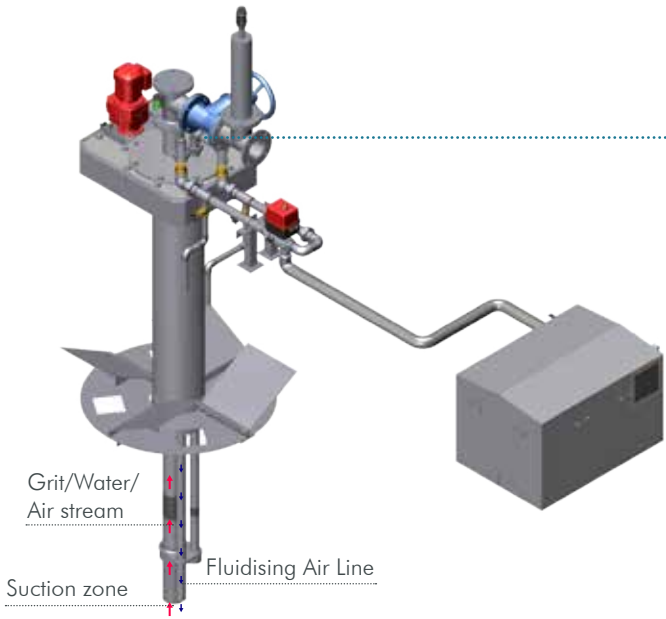

AIR LIFT SYSTEM

- ▶ Pressurized air from a rotary lobe blower provides fluidizing air or suction lift air through a three way valve to a classifier
- ▶ No restrictions or impeller in line thereby minimizing risk of blockages
- ▶ Simple operation, easy to maintain
- ▶ No impeller erosion as grit slurry is in contact with open pipe walls only
- ▶ Simple timer controls.

SELF-PRIMING GRIT PUMP SYSTEM

- ▶ SPIROPUMP® is a high capacity grit pump cycles to pump grit from bottom chamber to classifier.
- ▶ Self-priming pump designed for location above channel.
- ▶ Recessed anti-ragging impellor handles any objects which may not have been removed by the upstream screen.
- ▶ Simple timer controls.
- ▶ A second smaller pump may be used for sparging or fluidising the grit. Process water at high pressure could also be utilised for grit sparging or fluidising.

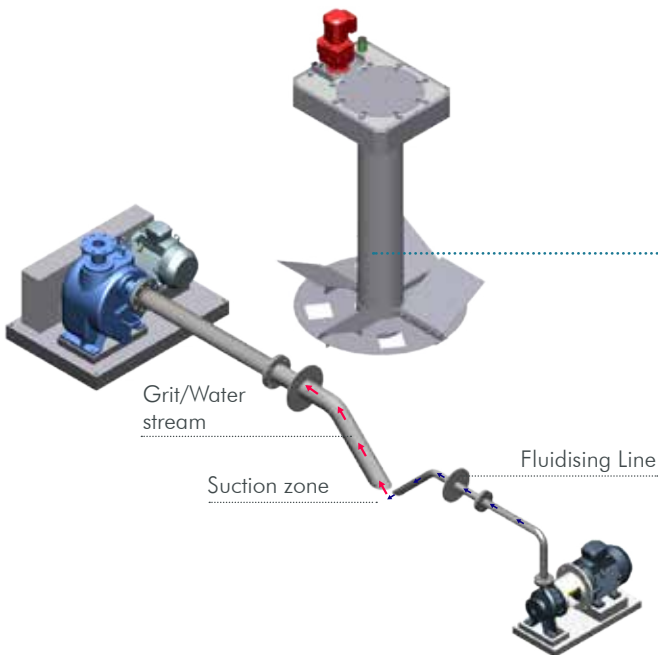
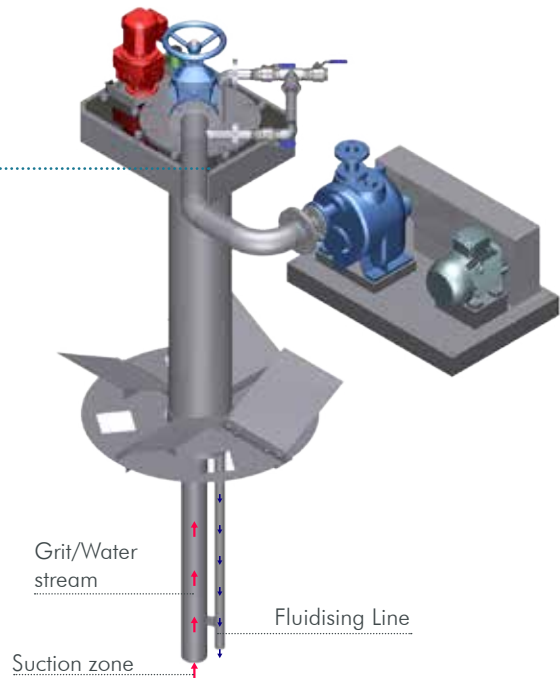

FLOODED SUCTION PUMP SYSTEM

- ▶ A high-capacity grit pump (SPIROPUMP®) cycles to pump grit from bottom chamber to classifier.
- ▶ Continuously primed pump designed for location below channel water-level.
- ▶ Recessed anti-ragging impellor handles any objects which may not have been removed by the upstream screen.
- ▶ Simple timer controls.
- ▶ A second smaller pump may be used for sparging or fluidising the grit. Process water at high pressure could also be utilised for grit sparging or fluidising.

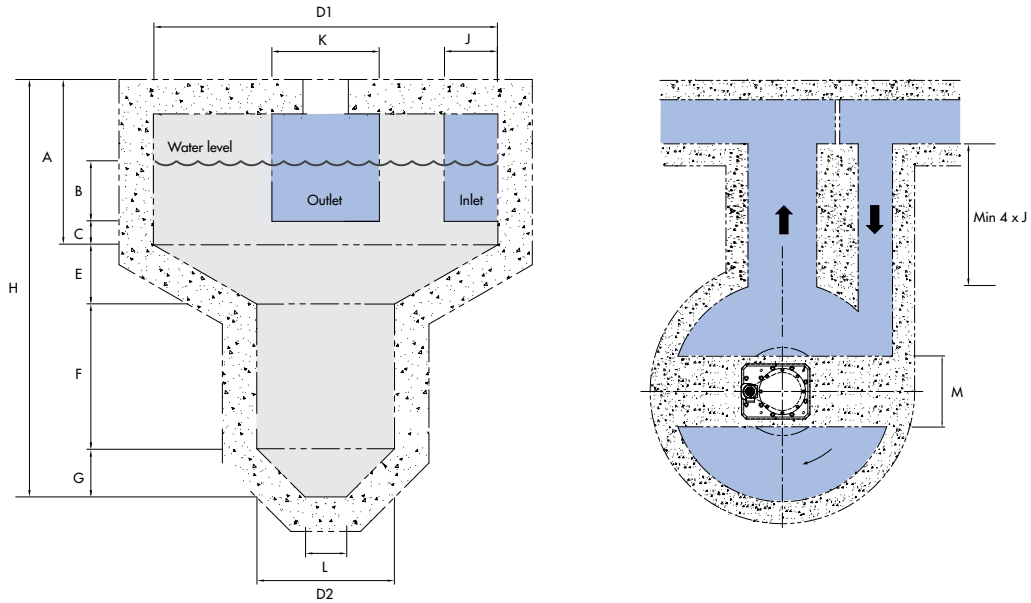

AVAILABLE OPTIONS

- Stainless steel or painted steel free-standing vortex tanks (in lieu of concrete)
- Variable speed impeller drive ● Blower acoustic enclosures ● PLC or electronic control packages

Model	Max Flow Rate (lps)	D1 (mm)	D2 (mm)	Chamber Volume (m ³)	H (mm)	A (mm)	B (mm)	C (mm)	E (mm)	F (mm)	G (mm)	J (mm)	K (mm)	L (mm)	M (mm)
VG10	35	1000	800	0.92	2310	1000	180	270	60	950	250	170	350	200	800
VG15	55	1500	800	1.54	2450	1000	180	270	200	950	250	270	500	200	800
VG20	84	2000	1000	3.12	2800	1110	210	310	290	1050	350	310	620	300	800
VG25	193	2500	1000	4.45	2830	1000	320	170	430	1050	350	390	780	300	800
VG28	230	2800	1000	5.61	3000	1030	350	120	580	1050	350	490	970	300	800
VG30	300	3000	1000	6.67	3010	1030	410	120	580	1050	350	490	970	300	800
VG35	473	3500	1500	11.62	3540	1260	470	170	580	1150	550	630	1240	400	800
VG40	628	4000	1500	19.76	4120	1400	580	390	720	1450	550	770	1550	400	800
VG45	772	4500	1500	29.73	5050	1980	600	640	870	1650	550	990	1980	400	800
VG50	968	5000	1500	36.49	5010	1800	620	600	1010	1650	550	1090	2180	400	800
VG55	1337	5500	1500	54.16	5750	2100	700	900	1150	1950	550	1200	2400	400	800
VG60	2056	6000	1500	66.61	5800	2000	760	890	1300	1950	550	1220	2400	400	800
VG65	2435	6500	1500	80.74	6090	2150	800	900	1440	1950	550	1350	2700	400	1000
VG70	2894	7000	1500	96.38	6280	2200	820	920	1580	1950	550	1500	3200	400	1000
VG75	3250	7500	1500	118.53	6680	2450	900	980	1730	1950	550	1500	3200	400	1000
VG80	3650	8000	1500	140.41	6880	2500	950	1000	1880	1950	550	1500	3500	400	1000

Dimensions are for information only and not to be used for design. Please contact us for more details.



1. TWO PAINTED MILD STEEL VORTEX CHAMBERS WITH FLOODED SUCTION PUMPS.
2. A SINGLE SELF-PRIMING GRIT PUMP FEEDING A SPIRAC SGW GRIT WASHER VIA A HYDROCYCLONE.
3. A SMALL UNMANNED PLANT INCLUDING AN AIRLIFT GRIT VORTEX SYSTEM.
4. VORTEX CHAMBER WITH FLOODED SUCTION GRIT PUMPS.
5. TYPICAL VORTEX DRIVE-HEAD AND AIRLIFT SYSTEM PIPING.



SPIRAC
WWW.SPIRAC.COM

AUSTRALIA

SPIRAC Pty Ltd

Western Australia (Perth)
+61 8 9434 0777

New South Wales (Sydney)
+61 2 8811 4100

Victoria (Melbourne)
+61 3 9717 1199

Queensland (Brisbane)
+61 7 3482 4230

info@spirac.com.au

NETHERLANDS

SPIRAC BV

Maarheeze
+31 (0) 495 430 203
info@spirac.nl

SWEDEN

SPIRAC AB

Limhamn
+46 40 36 22 00
info@spirac.se

UNITED KINGDOM

SPIRAC Limited

Banbury
+44 (1) 295 270 335
conveyors@spirac.co.uk

USA

SPIRAC (USA) Inc

Newnan GA
+1 770 632 9833
sales@spirac.com